

Measuring Supports and Auxiliary Equipment



TESA measuring supports have been designed to offer the best holding stability for instruments such as dial gauges, lever dial test indicators and probes. Stability is the prime requirement needed to reduce the related uncertainties in a measurement method or set-up.



A Base with vee recess and 1 magnetic flat face. Disengageable of magnet possible. Duralumin articulations.

 Dovetail clamp with a Ø 8 mm clamping bore

 0,4 kg

 Supplied without measuring instrument

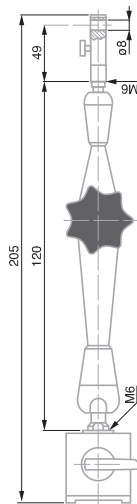

UNIVERSAL SUPPORTS

Magnetic measuring support with suction base or articulated arm.

INTERAPID Magnetic Support with Articulated Arm (small)



Magnetic support with articulated arm

No	=	N	H mm	L mm	Base mm	Consisting of:
01639025	Small magnetic measuring stand with articulated arm	≈ 170	205	120	30 x 30 x 30	<ul style="list-style-type: none"> – 1 articulated arm length 120 mm – 1 dovetail clamp with fine adjustment – 1 magnetic base 30 x 30 x 30 (L x W x H)

A Magnetic base has 1 prismatic and 2 flat faces. Articulations made from duralumin. Disengageable permanent magnet. Dovetail clamp with a Ø 8 mm clamping bore.

 Supplied without measuring instrument

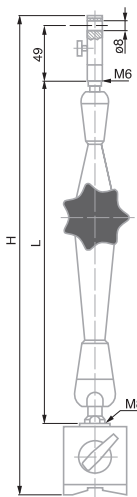

INTERAPID Magnetic Support with Articulated Arm

Simple and secure locking using a single rotating knob

- highly rigid arm and articulation.



Magnetic support with articulated arm

No	=	N	V-Base for Ø, mm	Fine adjust	H mm	L mm	Base mm	Mass kg	Consisting of:
01639022	INTERAPID magnetic support with articulated arm	≈ 800	30 ÷ 150	●	310	200	60 x 50 x 55	1,45	<ul style="list-style-type: none"> – Articulated arm – Clamp – Magnetic base
01639023	INTERAPID magnetic support with articulated arm	≈ 800	30 ÷ 150	●	390	280	60 x 50 x 55	1,85	<ul style="list-style-type: none"> – Articulated arm – Clamp – Magnetic base



INTERAPID Magnetic Support with High Precision Articulated Arm

Magnetic support with high precision articulated arm and fine adjustment for measurements that need repeatability in the range of μm .

Simple and secure locking with a two-position knob. Highly rigid arm and articulation.



Magnetic support with high precision articulated arm

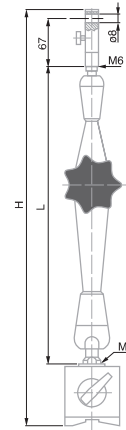

A Magnetic base has 1 prismatic and 2 flat faces. Articulations made from duralumin. Disengageable permanent magnet. Dovetail clamp with a $\varnothing 8$ mm clamping bore.

Supplied without measuring instrument

No	=	N	V-Base for \varnothing , mm	Fine adjust	H mm	L mm	Base mm	Consisting of:
01639053	INTERAPID High Precision Magnetic Support with Articulated Arm	≈ 1000	$30 \div 150$	●	440	320	73 x 50 x 55	<ul style="list-style-type: none"> Articulated Arm Clamp Magnetic base

INTERAPID Magnetic Support with Flexible Arm

For measurements in hard to reach locations. Instant and reliable locking through lever control.

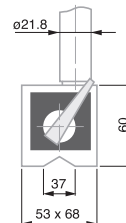

H Holding force on a flat surface ≈ 1000 N

A The magnetic base has 1 prismatic and 2 flat faces. Disengageable permanent magnet. Full length 350 mm. Dovetail clamp with an $\varnothing 8$ mm clamping bore.

Supplied without measuring instrument

No	=
01639020	Magnetic Support with Flexible Arm

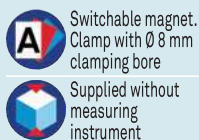

INTERAPID Inclinator Magnetic Support

Standard model and models with strong holding force



01639017



01639019

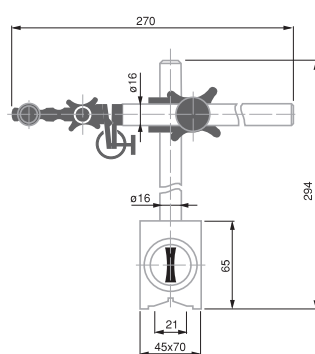

01639017

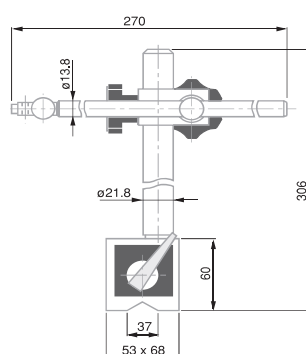

01639018

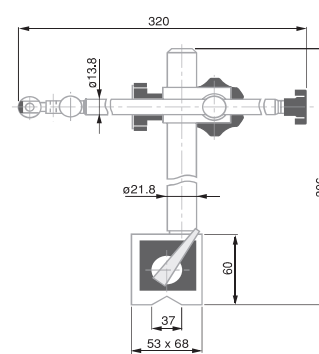

01639019



No	=	N	V-Base for Ø, mm	A	Fine adjust
01639017	INTERAPID magnetic support with V-base, 600 N	≈ 600	70 ÷ 220	Standard Version	●
01639018	INTERAPID magnetic support with V-base, 1000 N	≈ 1000	70 ÷ 220	Strong magnetic holding force	—
01639019	INTERAPID magnetic support with V-base, 1000 N	≈ 1000	70 ÷ 220	Strong magnetic holding force	●



INTERAPID Support with Suction Base and Articulated Arm

Holds firmly on any smooth and flat surface

- Clamps instantly and reliably using a suction lever switch.
- Highly rigid articulated arm.
- Free from magnetic fields.

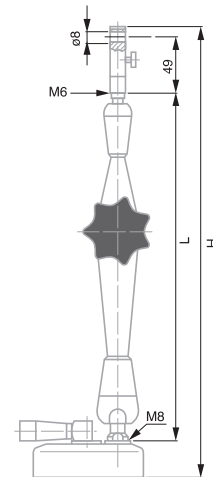



A Round suction base made of aluminium (Ø 88 mm, height 28 mm) with flat suction base. Articulations made from duralumin. Suction controlled by lever switch. Dovetail clamp with an Ø 8 mm clamping bore.

1.1 kg

Supplied without measuring instrument

No	=	N	Fine adjustment	H, mm	L, mm	Consisting of:
01639024	INTERAPID Measuring support with suction base and articulated arm	≈ 400	●	363	280	<ul style="list-style-type: none"> - Articulated arm - Fine adjust clamp - Round suction base

 Measuring table and column in hardened steel.

 Measuring arm with Ø 8 mm clamping bore, without fine adjustment. Measuring span: 48 mm.

 2,7 kg

 Supplied without measuring instrument

INTERAPID Small Measuring Support and Table Ø 49 mm

Round steel measuring table

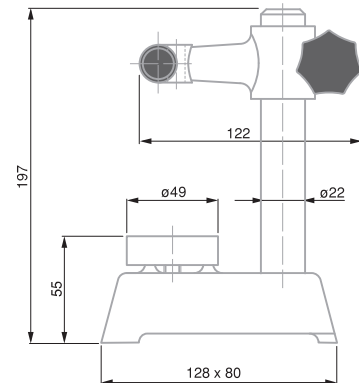

Application example with DIGICO indicator

No

=



mm
0 ÷ 100



mm
49

01639006 INTERAPID small support with Ø 49 mm measuring table

 Cast iron base

 Base with front support face. Clamp for Ø 8 mm mounting rod or dial gauge with lug back. Model No 01639003 also with dovetail clamp.

 1,3 kg (01639003)
4,35 kg (01639004)

 Supplied without measuring instrument

INTERAPID Measuring Support with Inclined Frontal Arm



01639003

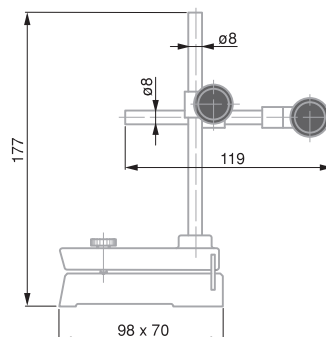

01939003



01639004

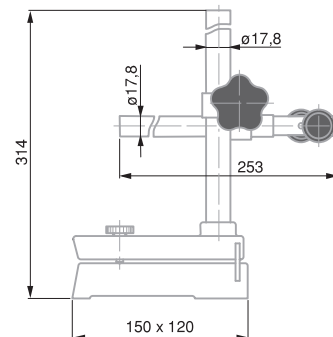

01939004

No

=



Used in conjunction with:

01639003 INTERAPID Measuring Support with Inclined Frontal Arm H = 177 mm

Lever dial test indicators, small dial gauges

01639004 INTERAPID Measuring Support with Inclined Frontal Arm H = 314 mm

Lever dial test indicators, small dial gauges, precision indicators, probes etc.



INTERAPID UA 1 Table Measuring Support with Ground Table Surface

Basic model without fine adjustment

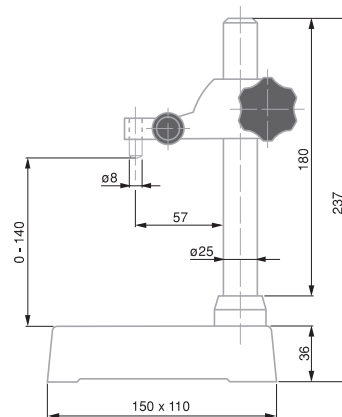

 Measuring table:
cast iron. Column:
chrome-plated
steel, Arm:
spheroidal graphite
cast iron.

 Measuring surface
of table: ground.
Column: Can be
dismantled.
Measuring arm with
Ø 8 mm clamp.

 3 kg

 Supplied without
measuring
instrument

No

=

mm

mm

01639008 INTERAPID UA 1 measuring support with table

0 ÷ 140

100 x 100

INTERAPID UD12 Support

Medium sized mobile measuring support for use with every type dial test indicators, dial gauges, precision indicators, electronic probes etc.

With fine adjustment mechanism.

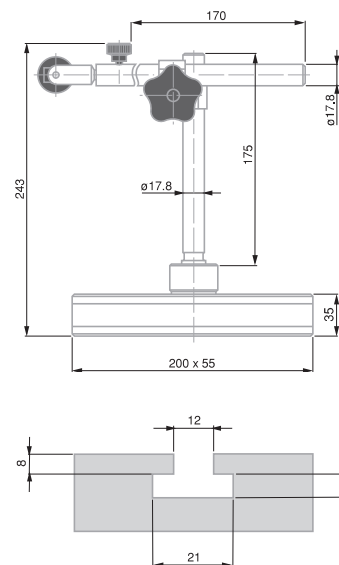

 Cast iron base

 Stand with lateral
guiding faces. T-slot
for vertical column.
2 rigid articulations

 3.3 kg

 Supplied without
measuring
instrument

No

=

01639000 UD 12 universal support

COMPOSÉ DE:

01840105 Tige de fixation à queue d'aronde Ø 8 mm

01640100 UDZ 3 Mounting rod and UDZ3 clamp Ø 8 mm clamp for UD 12

3 µm in accordance with DIN 876 T1, class 00

01639035: black burnished column with Ø 8 mm clamping bore.

01639029: chrome plated column with thread and threaded ring for adjusting the height of the measuring arm. Ø 8 mm clamping bore. Grooved measuring face.

01639033: Chrome plated column. Horizontal sliding arm. Ø 4 mm or 8 mm bore for a dovetail clamp or lug.

Supplied without measuring instrument

INTERAPID Table Measuring Stands with Granite Grade 00

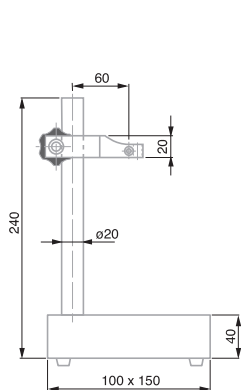

01639035

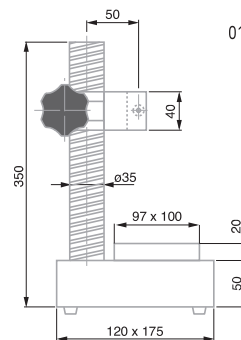

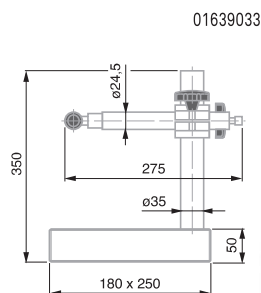

01639029



01639033



No	=									
01639035	Table measuring support with granite, column Ø 20	0 ÷ 170	20	Granite	–	100 x 150 x 40	200	100 x 115	50,0	2,6
01639029	Slotted table measuring support with granite, threaded column Ø 35	0 ÷ 225	35	Hardened steel	●	120 x 175 x 50	300	100 x 100	68,5	8,1
01639033	Table measuring support with granite, column Ø 35	0 ÷ 260	35	Granite	●	180 x 250 x 50	300	180 x 200	Adjustable	10,5



SMALL MAGNETIC SUPPORTS

Ideal for lever type dial test indicators, and dial gauges up to 40 mm diameter
- With 2 articulation joints and fine adjustment.

Small magnetic support UJ 15

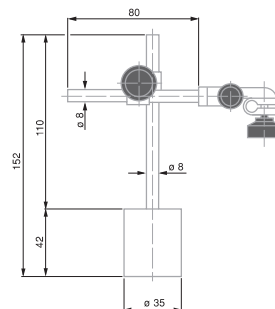

01639007 + 01640501
with dial test indicator



01639007 Magnetic support INTERAPID UJ15, dovetail clamp and Ø 8 mm cylindrical clamping

Small magnetic support UJ 15G

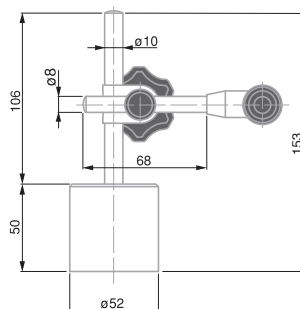

01639016 UJ Magnetic support

Accessories for Small Magnetic Stands



01640501 Steel base plate for UJ15 or UJ15G that become movable

 Holding force
on a flat surface:
≈ 220 N

 Rounded base
with permanent
magnet

 0,47 kg

 Supplied without
measuring
instrument

 Holding force
on a flat surface:
≥ 350 N





 Rounded base
with permanent
magnet

 0,93 kg

 Supplied without
measuring
instrument

 50 x 80 x 20 mm

 0,60 kg



-  Cast iron table. Chrome plated steel column
-  Support base: Ground measuring face. 2 T-slots. Removable column.
-  Supplied without measuring instrument
-  Support base only: 4,85 kg
Measuring arm: 0,85 kg
Sliding arm: 1,75 kg

UA 30 MEASURING STAND

Base for mounting special fixtures adapted for series inspection

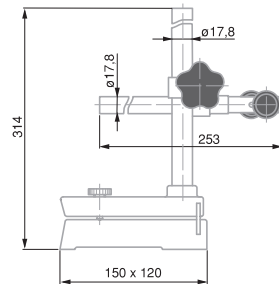
INTERAPID UA 30 Measuring Stand, Without Measuring Arm



No	=			
01639009	INTERAPID UA 30 measuring support with table, without measuring arm	mm 0 ÷ 175	in 0 ÷ 6.89	mm 125 x 115

-  Measuring arm 01610200: With fine adjustment. 1 mm travel. Ø 8 mm clamping bore. Sliding arm 01610201: Sliding holder for TESA YA dial gauges. Adjustable swinging movement. Clamping bore Ø 13 mm. Length of travel 35, 57 or 80 mm. Measuring span 60 mm. Depth stop plate 01640000: Dimensions: 115 x 35 x 3,5 mm. 120° vee recess for Ø ≤ 120 mm, 2 tightening screws.

Accessories for UA 30



01610200



01610201



01640000

No	=
01610200	UK 20 measuring arm with fine adjustment for UA30 support
01610201	UK 25 sliding arm. Used with TESA YA for stationary bore measurement on UA30 support
01640000	UAZ 10 depth stop plate for UA 30

